

## CD-960

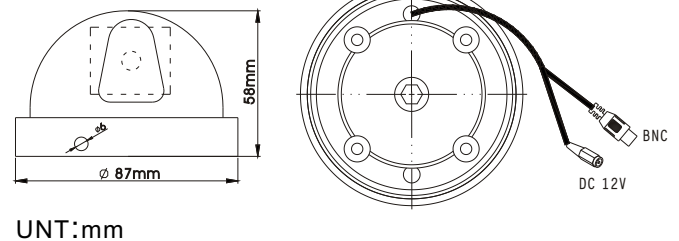

### DIMENSION



### FEATURE

- 1/4" SONY CCD. High Quality and Sensitivity.
- Saturated, Natural and Brilliant Color Displays.
- Resolution: 420 TVL
- Surge-protection Design.
- New Energy-Saving Technology Provides Low Power Consumption.

### SPECIFICATION

VIDEO SYSTEM	NTSC	PAL
PICK UP ELEMENT	1/4" SONY CCD	
NUMBER OF PIXEL	510 (H) × 492 (V)	500 (H) × 582 (V)
PICTURE ELEMENTS	APPROXIMATELY 250K	APPROXIMATELY 290K
HORIZONTAL RESOLUTION	420 TVL	
SCANNING SYSTEM	2:1 Interlace/Internal synchronization	
SENSITIVITY	0.1 LUX	
S/N RATIO	48dB	
ELECTRONIC SHUTTER	Auto	
GAIN CONTROL	Auto 0~12dB	
WHITE BALANCE	Auto	
BACK LIGHT COMPENSATION	Auto	
LENS MOUNT	4 mm ; Horizontal angle 52°	
VIDEO OUTPUT	BNC ; 1.0Vp-p 75Ω	
POWER SUPPLY	DC12V	
POWER CONSUMPTION	100 mA/ a kilowatt-hour for monthly use	
DIMENSIONS	Ø 87 x H58 mm	
WEIGHT	About 105 g	